

the news



PHILADELPHIA SECTION

AMERICAN SOCIETY OF CIVIL ENGINEERS

P. O. Box 58186, Philadelphia, PA 19102-8186

Electronic Message Hotline: (215) 934-3639 (24 hours a day)

FIRST CLASS MAIL

Presorted
1st Class Mail
U.S. Postage Paid
Philadelphia, PA
Permit No. 1845

Vol. 68-1

Our 82nd Year

October, 1995

OCTOBER JOINT DINNER MEETING

Philadelphia Section, American Society of Civil Engineers
Philadelphia Chapter, Pennsylvania Society of Professional Engineers

THURSDAY, OCTOBER 12, 1995

WILLIAMSON'S • GSB Building • City Line Ave. • Philadelphia • (See Location Map Below)
Cocktails - 5:30 p.m. • Dinner - 6:30 p.m. • Meeting - 7:30 p.m.

SUBJECT: The Port of Philadelphia and Camden; A Major U.S. Seaport Looks to the Future
SPEAKER: Paul D. DeMariano, President and Chief Executive Officer, The Port of Philadelphia and Camden, Inc.

SPONSORED BY: Engineering Management Group, **Dennis MacBride**, Chairman; Meeting Arrangements by **Al Zion**, President-Elect

"FOCUS" FIRMS: Urban Engineers, Inc.; Philadelphia Dept. of Streets; Tony DePaul & Sons

SPECIAL FEATURE: VILLANOVA UNIVERSITY NIGHT

The ASCE Student Chapter, Alumni and Faculty of the Civil Engineering Department of Villanova University will be honored at this meeting. All Students, Faculty, and Alumni are cordially invited.

The Port of Philadelphia and Camden is at the heart of one of the most vibrant and important commercial, industrial and maritime complexes on the North American continent. For over 300 years it has served this region and the nation as an important gateway of commerce and trade. Now, as the 21st century approaches, it is poised to grow and meet the challenges of a new and evermore competitive global marketplace. The states of Pennsylvania and New Jersey have created a new agency to manage cargo facilities on both sides of the Delaware River. On November 1, 1994, **Paul D. DeMariano** was appointed as the first President and Chief Executive Officer of "The Port of Philadelphia and Camden, Inc." He is now overseeing the unification process that will merge the Philadelphia/South Jersey region's disparate port agencies into a single port administration.

Mr. DeMariano's appointment is the culmination of a maritime career of almost 30 years. He is a graduate of the University of Massachusetts and has completed post graduate work at Suffolk University Law School. He has worked as Vessel Superintendent for the Massachusetts Port

(Continued on Page 2)

RESERVATIONS ARE REQUIRED. Please send your check for the number of attendees @ \$25 per member or guest; \$13 ASCE Student members, payable to the Phila. Section, ASCE, P.O. Box 58186, Phila. PA 19102-8186; or call the Electronic Message Center: **(215) 934-3639** (open 24 hours/day). Deadline for reservations is **Monday, October 9, 1995.**

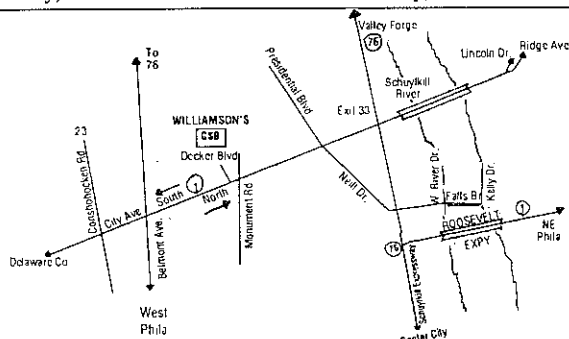

LOCATION MAP
for
Williamson's
GSB Building,
City Line Ave.,
Philadelphia

TECHNICAL GROUP ACTIVITIES

Geotechnical and Environmental/ Water Resources Groups

(Combined Program for 1995-96)

October Meeting

Date: **Tuesday, October 10, 1995**

Location: Hill Seminar Room, LeBow Engineering Center, Drexel University, 31st & Market Sts., Phila., PA

SUBJECT: Adsorption of Lead in Fly Ash Subgrades for Waste Disposal Facilities

AUTHORS: Timothy M. Laumakis, Project Engineer, CH2M Hill, Phila., PA; **Joseph P. Martin**, Assoc. Professor, Civil Engineering Dept., Drexel University, Phila., PA; **Sibel Pamucku**, Assoc. Professor, Civil Engineering Dept., Lehigh University, Bethlehem, PA; **Kevin Owens**, Assoc. Professor, Chemistry Dept., Drexel University, Phila., PA

To minimize contaminant releases to groundwater from landfills, mining facilities, and transfer stations, the traditional emphasis has been on hydraulic containment by liners and collection systems. There has also been interest in the capability of a liner and its subgrade to attenuate contaminant concentrations. The latter has received more attention recently as an added dimension of environmental protection if long term problems arise in the primary containment system.

This presentation investigates the properties of an Appalachian bituminous fly ash for potential use as environmental facility subgrades. The concentration is on the ability of the fly ash to limit impacts of an acidic leachate with a high lead content, i.e., restrict seepage rate, neutralize the effluent and most importantly, retard lead migration.

For further information on this or future meetings please contact **Timothy Laumakis** at CH2M Hill, (215) 563-4220.

Engineering Management Group Seeks Members' Ideas

The Phila. Section, ASCE Engineering Management Group held its 1995-96 program meeting

(Continued on Page 3)

PHOTO
TO APPEAR
NEXT MONTH

THE PRESIDENT'S MESSAGE

As I compose this first message to the Section, your new Board of Directors is busy trying to arrange another spectacular program of technical meetings. Considering the great job done last year with **Bill Thomsen**, that's quite a challenge. But this year's Board has shown a tremendous amount of energy and I'm sure is up to it. **Al Zion** has moved up to President-Elect and **Darin Gatti** to Vice President. We've gotten a transfusion of new talent with **Dennis MacBride**, **Faruq Siddiqui**, and **Rich Markwith** (former Membership Secretary) serving as new Directors, and with **Linda Crownover** as Asst. Secretary. Other

Board members have remained or have shifted positions from last year, so I've got a great team to work with.

As a preview for this year, our plans include a trip to Spectrum II, as well as a series of technical presentations including port unification, the Walt Whitman Bridge rehabilitation, and the environmental challenges of the airport runway project. Joint meetings are in store with ASHE, SAME, PSPE, and the South Jersey Branch ASCE Section. We plan to continue the Drexel Geotechnical Seminar, our Spring Social and last year's new addition — the golf outing. We hope that there's something for everyone.

We plan to implement the "Civil Engineering Focus" at the technical sessions as envisioned by the Board last year. At our meetings at Williamson's Restaurant, an owner, firm, and/or engineering organization can present a poster or other representation for viewing during the cocktail hour. Details will be available in THE NEWS.

I'm told that each President is supposed to present his or her "platform" for the year. Without taking myself too seriously, as this is a volunteer organization and I'd like us all to have fun while going about it, here is mine:

1. **Everybody's Welcome!** — ASCE National is going through a difficult time trying to determine what the Society is all about and who should be members. While that's all well and good, my message to you is that if you're interested in the Philadelphia Section and what we're doing, we're interested in having you. Please come and feel welcome.

2. **A Strong Technical Program** — It is my firm belief that the best thing the Board can do for you is to establish as strong a monthly technical program as possible, covering a range of topics of interest to the membership. That's our top priority.

3. **Efficient Board Meetings** — This is a housekeeping item, of less concern to the general membership, except that long Board meetings tie-up the Board during the meet-and-greet cocktail hours at monthly meetings when we should be circulating among you. I pledge to get the meetings concluded on time.

4. **The Humphrey Fund** — During the course of the year, I'd like to inform and educate the membership at large on the Humphrey Fund. This rather unique and remarkable investment source provides the Philadelphia Section with a degree of financial security other technical organizations and societies only dream about. The guidance that the Board has been using to oversee the Fund dates back to the 1970s and I would like to seek the guidance of the membership as a whole in how to administer these funds. More on this in upcoming issues of THE NEWS.

I look forward to meeting and talking with each of you during the upcoming year. Please come to the meetings, participate, and most importantly, enjoy!

Sincerely, William G. Richard, PE; President, Phila. Section, ASCE

October Dinner Meeting

(Continued from Page 1)

Authority's Castle Island Terminal, as Port Director for the Port Everglades Authority, as Vice President of Port Development for the Eastern Seaboard Petroleum Company, and as Managing Director of the Jacksonville Port Authority where he served as the Authority's Chief Executive Officer. During his tenure in Jacksonville, he implemented a \$55 million capital improvement program.

Mr. DeMariano will draw upon his expertise and years of experience to oversee the most ambitious regional port unification effort in modern history and, to design strategies to significantly expand the region's cargo base. At the meeting, Mr. DeMariano will bring us up-to-date on the status of the Port reorganization and discuss projects which are envisioned to prepare the Port to meet the challenges of the next century.

LINDA CROWNOVER JOINS THE NEWS

THE NEWS is pleased to announce the appointment of **Linda M. Crownover**, Project Director, Roy F. Weston, Inc., Philadelphia, PA, as Associate Editor. Ms. Crownover is also Philadelphia Section, ASCE, Assistant Secretary, 1995-1996. Another principal support role in which she will serve on the Board of Directors is assisting Section President Bill Richards in his administrative duties.

Ms. Crownover, who holds a B.A. in Distributed Studies from Western Illinois University, has worked in the Information Management arena for over 15 years, serving a wide range of Municipal and Federal clients. Her areas of expertise include infrastructure and facilities management, geographic information systems, environmental management, and strategic planning and development.

THE NEWS and the Philadelphia Section Board are happy and proud to welcome this talented new addition to its ranks.

**PLACE YOUR
BUSINESS CARD AD
IN THE NEWS.
FOR INFO,
CONTACT
BOB WRIGHT
at (215) 686-5538**

PHILA. SECTION, ASCE OFFICERS 1995-1996

PRESIDENT

William G. Richards

PRESIDENT-ELECT

Alvin Zion

VICE PRESIDENT

Darin L. Gatti

SECRETARY

Gregory R. Yates

ASSISTANT SECRETARY

Linda M. Crownover

TREASURER

Jian Jin

MEMBERSHIP SECRETARY

Sean W. Markey

DIRECTORS

Sandra J. May Dennis M. MacBride
Chris L. Rood Richard P. Markwith
Frederick C. Schmitt Faruq Siddiqui
Samir Serhan, President, Reading Branch

PAST PRESIDENTS

Klaus K. Fuelleborn • Robert M. Wright
William T. Thomsen

President - William G. Richards

Roy F. Weston, Inc.
Suite 1515
1515 Market Street, Phila., PA 19102
(215) 841-2015, fax (215) 841-2040

Secretary - Gregory R. Yates

Urban Engineers Inc.
Penn Mutual Tower, Suite 1630
530 Walnut St., Phila., PA 19106
(216) 923-5077; fax (215) 923-5611

PUBLICATIONS COMMITTEE

Chairman and Editor of THE NEWS

Sidney Robin

Associate Editor — Linda M. Crownover

Staff Writers

Wm. G. Richards Joe Syrnick Bob Wright

SEND COPY TO:

Sidney Robin
64 Nancy Drive
Richboro, PA 18954
(215) 322-7464

**COPY DEADLINE FOR
NOVEMBER 1995 ISSUE
OCTOBER 12, 1995**

YOUNGER MEMBER FORUM NEWS

by Christopher Menna, Forum Editor

The Philadelphia Section, ASCE Younger Member Forum (YMF) is comprised of younger individuals associated with Civil Engineering. The current membership includes college students, recent graduates, and young registered Professional Engineers. The objectives of this Group are:

- 1) To provide networking opportunities,
- 2) To work with colleges and secondary schools in the hope of attracting interested students to the engineering profession,
- 3) To develop leadership skills,
- 4) To provide a smooth transition for Young Members into the Philadelphia Section and National ASCE activities,
- 5) To recognize young engineers in the region,
- 6) To encourage community involvement,
- 7) To promote career development.

Any college student or other young engineer who would like to become part of the YMF please contact **Dave Hanly**, Frederick R. Harris at (215) 735-0832.

Past Accomplishments

Over the past year, the YMF has grown from a fledgling effort of a couple people to more than 67 members!!

The Community Affairs Committee sponsored a Habitat for Humanity Saturday Workday at Norristown's Buttonwood Street Project this past June. Ten of our members participated. It was a resounding success.

As of September 1995, the YMF added an honored guest to its monthly meeting format. The Group hopes to gain some insight as well as some advice from its invited speakers. A special thanks goes out to **Mr. Thomas J. O'Brien, CPG** for being the guest at the September 1995 meeting. Mr. O'Brien is the office manager at NTH Consultants, Ltd., located in Exton, Pennsylvania.

Upcoming Events

Any college Senior Design Group from the Greater Philadelphia Area wishing to have project advisors may contact **Brian Saks, A.G.** Lichtenstein Engineers at (215) 752-2206.

A joint umbrella group meeting with the younger members of the Engineers' Club of Philadelphia, SAME, and ASHE is scheduled for **Tuesday, October 17, 1995**. The topic will be "Engineering: Your Changing Profession." Contact **Mitch Sklar, STV**, Sanders and Thomas at (610) 326-4600 for more information.

Member Spotlight

The purpose of the Member Spotlight is to introduce a fellow YMF member to the Delaware Valley Engineering Community.

Linda Armour, PE is a Project Engineer at Cagley, Harman, and Leisk, Inc. in King of Prussia, PA. In this position, Linda is involved with many parts of a project, including design, scheduling, and budgeting. Currently, Linda is involved with the structural modifications of the Abington Senior and Junior High Schools. In addition, she participated in the sheeting and shoring design of the streets surrounding the Temple Uni-
(Continued on page 7)



LEGISLATIVE CORNER

By Mark S. McKain, Esq.

Proposed Amendments to the Architects Licensure Law

Editor's Note: As announced in the April/May, 1995 issue, THE NEWS, on the initiative of Phila. Section Past President Bill Thomsen, is pleased to resume, with this issue, the "Legislative Corner" column, authored by Mark S. McKain, Esq.

In June 1995, House Bill No. 1953 was introduced to the House Licensure Committee to amend the Pennsylvania Architects Licensure Law. The proposed legislation would exempt the design of certain residential dwellings from the "practice of architecture" and would also permit architects to enter into design-build contracts. The proposed changes would also have an impact on the practice of engineering in Pennsylvania.

Section 34.3 of the Architects Licensure Law was amended by adding the language that would exempt the design of "one-family or two-family residential dwellings" from the practice of architecture. Under the existing law, Section 34.15(4), the exclusion was only given to single family dwellings designed by those who intended to occupy the home.

One reason for the proposed change may relate to the development of large residential subdivisions. A contractor will retain an architect to design and seal the plans for several different models that will be offered to potential buyers. Once a set of "canned" plans is prepared for each model, the question arises as to whether the architect must seal the plans for every home built within the subdivision. Since the construction of each home falls within the existing definition of the "practice of architecture", an architect is required to seal each set of plans. The tension between the builder and architect arises from the cost associated with the builder using a set of sealed plans to construct each home and the issue of who absorbs the cost — the contractor or buyer.

The proposed change would not, however, do away with the need for an engineer to be part of the design process. The Engineer, Land Surveyor and Geologist Registration Law would still require engineering evaluations, particularly in the area of structural integrity. Engineers would also benefit because the proposed change would permit them to engage in design formerly reserved for architects, and design not previously believed to be "incidental to their engineering work", as now provided in 34.15(2).

The downside of the proposed change to the Architects Licensure Law would be to invite non-licensed persons to engage in the design of single and two-family dwellings.

The advisory opinion was issued in response to numerous inquiries by architects concerning the legality of design-build projects in Pennsylvania. The Board advised its membership that Licensure Law only permitted licensed architects to provide architectural services. Non-architects were prohib-

ited from offering architectural services even when an architect performed the services. The Board advised that a separate contract was required between the owner and the architect.

The Board suggested two alternative scenarios to address the prohibition against design-build contracts. The first scenario was for an architect and contractor to form a business entity for the purpose of providing architectural services. The architect had to own at least 50% of the business. The second scenario involved the owner assigning its contract with the architect to the contractor. The purpose of either scenario was to ensure that the architect maintained an independent relationship to the owner.

The proposed change to the Licensure Law would permit "construction contractors or engineers" to practice architecture as long as they employ or subcontract with a licensed architect to perform the work. Arguably, the control of services that formerly fell within the "practice of architecture", as defined in Section 34.3 (planning, preliminary studies, designs, specifications, construction management and construction administration, etc.) would shift to the construction contractor or engineer in a design-build relationship with an architect.

The bill to amend the existing Architects Licensure Law was introduced to the House Licensure Committee just prior to the 1995 summer recess. What action the committee will take when it returns in the fall is not known. However, if public hearings are held or the committee moves the bill forward, one would expect resistance from the architects.

If the bill is enacted as now drafted, it will have mixed effects on the practice of architecture and engineering. It will decrease an architect's autonomy over residential design while permitting an architect to engage in design-build relationships. It will benefit engineers by permitting increased involvement in residential design. The downside is that the proposed changes will invite and permit non-licensed individuals to provide residential design services — something that will not benefit architects or engineers.

I will keep you advised of any updates.

Technical Group Activities

(Continued from Page 1)

in September and is looking for your ideas for activities on the latest developments in engineering management. The Engineering Management Group is dedicated to informing Section members of the latest developments in managing the engineered project. We have sponsored programs on TQM, engineering ethics, engineers' compensation, etc., and coordinated tours of Philadelphia's major projects such as the Pennsylvania Convention Center, International Airport and SEPTA's Railworks. If you are interested in sharing your ideas for our 1995-96 program or if you have any questions, contact me at (215) 580-7084 (work) or (609) 768-7743 (home). Thank You. Sincerely,
Dennis MacBride, Chairman.

APRIL DINNER MEETING

April 20, 1995

Williamson's GSB, City Line, Phila., PA

Philadelphia International Airport Expansion Update

By Bill Richards, Staff Writer

In one of our best attended technical meetings of the year, about 120 members, students, and guests gathered at the Section's April Dinner Meeting. Following the Section's monthly Board of Directors meeting, the cocktail hour, and an excellent dinner, President **William T. Thomsen, P.E.**, presided over the technical session. Principal speaker was **Mary Rose Loney**, Director of Aviation, the City of Philadelphia, who presented the ongoing improvement program at Philadelphia International Airport. Her talk was: "Philadelphia International Airport - Things Are Looking Up."

President Thomsen recognized ASCE District 4 Director, **Dr. Joel Abrams**, who had previously participated in the Board of Directors meeting prior to the Main Section Meeting. Dr. Abrams reviewed National ASCE programs of interest and relevance to the Philadelphia Section.

President Thomsen also made a presentation to ASCE Student Member **Michael Tantal** (son of section Past President Al Tantal), a University of PA Student Chapter officer, the 1995 Shimizu Corp. Essay Contest Award — a \$3,000 Scholarship.

Temple University Night

Continuing its policy of many years of honoring the ASCE Student Chapters and Civil Engineering Departments of six area colleges and universities, the Philadelphia Section focused this meeting on Temple University's Student Chapter, alumni and faculty of the Civil Engineering Department. An excellent turnout of more than 30 Temple representatives attended.

Dr. Frederick C. Schmitt, Chair of Temple's Civil Engineering Department, and current Director of the Philadelphia Section, thanked the Section for its courtesies; and he reviewed his Department's activities and engineering programs — from Technology to Advanced Degree Courses. Dr. Schmitt introduced the faculty members and Civil Engineering undergraduates in attendance.

ASCE Student Chapter President Speaks

Dr. Schmitt introduced Temple ASCE Student Chapter President **Carl Corse**, who acknowledged his fellow officers: **Megan Gebhardt**, Vice Pres.; **Nhan Huynh**, Secretary; and **Janice Doleski**, Treasurer; also, **Dr. Bechara Abboud, P.E.**, Student Chapter Faculty Advisor.

President Corse reviewed the history of the Temple ASCE Student Chapter, and described its new goals. Foremost among these is the initiative to re-create an active and vibrant group and to enjoy doing it. The Chapter has grown from a nucleus of 4 or 5 members to its present 40 plus, and it is building the base for an even stronger organization in the future. He thanked the Philadelphia Section for its invitation and tributes.

Mary Rose Loney Introduced

President Thomsen presented Philadelphia

ASCE Section President-Elect **Al Zion**, who introduced our featured speaker, **Mary Rose Loney**, Director of Aviation for the City of Philadelphia including Philadelphia International Airport and Northeast Philadelphia Airport. In this capacity, she directs all airport operations, including maintenance, fiscal affairs and planning, and construction of the capital improvement programs. The airport system is totally self-supporting, with an annual budget of \$121 million to meet operating, maintenance and debt service needs. Ms. Loney oversees a staff of 560 employees; the total airport employee population is 9,000. Prior to becoming Philadelphia's Director in 1993, Ms. Loney was Deputy Executive Director, Finance and Administration, for Dallas/Fort Worth International Airport (the world's second busiest airport); First Deputy Commissioner of Aviation for the city of Chicago in charge of operations of O'Hare International (the world's busiest airport); Assistant Director of Aviation for both San Jose International Airport and Albuquerque International Airport; and Airport Services Manager for McCarran International Airport in Las Vegas. Ms. Loney began her career in the aviation industry by marketing air tours of the Grand Canyon for Grand Canyon Airlines. She holds a Masters Degree in Public Administration (M.P.A.) from the University of Nevada and a Bachelor of Arts Degree (B.A.) from the University of Pittsburgh.

The Phila. International Airport Complex

The Philadelphia International Airport (PHL) is a truly regional facility, serving Pennsylvania, New Jersey, and Delaware. Located on 2200 acres, the airport has 5 terminals, 3 runways, and about 40 miles of paved roadways and runways. 1994 was a truly record-breaking year for the facility, with 17.2 million passengers and 403,000 takeoffs and landings. In her presentation, Ms. Loney detailed 1994 accomplishments, 1995 initiatives, passenger and cargo air service development, and the upcoming Runway 8-26 project.

PHL 1994 Accomplishments

- Selected the master developer to manage new food, beverage and retail concessions at the airport. The agreement involves placing 140 concession units within 100,000 sq. ft.
- Completed the \$45M renovation of terminals B, C, D and E.
- Launched the Airport Customer Excellence (ACE) Program, a motivational and incentive program to obtain superior service from the 9000 airport employees.
- Implemented a series of ground transportation improvements, including a new taxi dispatch system, more convenient pickup zones, and new signs.
- Obtained a ruling allowing the airport to proceed with land acquisition and construction of the new 8-26 Runway.

PHL 1995 Initiatives

As the first step in the new concession program, interim merchandise and food carts have already been deployed throughout Terminals B, C, and D. These are the first of many steps to offer the traveling public locally based food and retail products at street prices.

A major initiative is the \$90M B/C terminal consolidation project. Scheduled for completion in mid-1997, its major components include:

- A new combined baggage claim to rectify U.S. Air's current bifurcated operation. The new claim area will span 750 feet and include a new underground delivery tunnel. New technology will increase speed, enhance sorting, and provide more information display systems.
- A 45,000 concession retail mall.
- A 500 foot ticketing pavilion located at the entrance, with more than fifty positions, one-fourth for international flights.
- Moving sidewalks between Concourses B and C, on the bridges to baggage claim and on the pedestrian bridge between Terminals A and B.
- Larger, faster flowing security checkpoints.
- A 20,000 sq. ft. U.S. Air Club and business center on the third level of the terminal.

Additional initiatives include improvement to public parking facilities, new security controlled access and fire alarm systems, and expansion of ground transportation dispatch programs.

Air Service Development

The airport has recently witnessed rapid air service expansion with the arrival of five new carriers. New air service has begun to Boston and Pittsburgh (via Nations Air), and to Cincinnati and Providence (via Comair). In June, U.S. Air was to initiate service to Frankfurt. The airport was proactively seeking to re-establish a second daily flight to London; this was accomplished subsequent to our April meeting.

Cargo activity has shown a dramatic increase since 1988, with an annual growth of 12.6 percent. This has been driven by the superior service and success of integrated cargo carriers, by providing door-to-door service, guaranteed delivery time and high shipment tracking capabilities. Integrated carriers account for 80 percent of outbound cargo at the airport.

PHL's cargo took its biggest jump from '93 to '94 by growing 28.5 percent, primarily as a result of UPS hub activity and the initiation of international service to East Midlands and Cologne. However, JFK in New York still accounts for 47 percent of the total exports from the tri-state area. PHL is continuing to regard the international development of its cargo activity as an important challenge.

Runway 8-26 Project

Described as the "crown jewel" in the airport's capital development program, Runway 8-26 is the only new runway construction project being undertaken in the U.S. Combined with the existing cross-wind runway, 8-26 will provide a separate take-off and landing system for commuter traffic, which accounts for 45 percent of the

(Continued on page 6)

SECTION 1995 AWARDS PRESENTED AT SPRING SOCIAL

By Bob Wright, Staff Writer

The Section Awards for the 1994-95 season were presented at the Phila. Section, ASCE, Annual Spring Social and Dinner Dance, on Friday, May 5, 1995, at the Sugarloaf Conference Center in Chestnut Hill. The Social was attended by nearly 140 people, who enjoyed the "Cinco de Mayo" theme of the event as well as inspiring and somewhat humorous speeches offered by outgoing President **William Thomsen** and current President **William Richards**. The Social additionally marked the induction of new Officers and Board Members, with Past President **Robert Wright** presenting the oath of office to the incoming slate.

The recipients of Section awards were cited with the audio-slide show that has become a tradition at the Social over the past several years. A total of six Section members were recognized for honors.

Philadelphia Civil Engineer of the Year

Edward M. D'Alba, the President and Chief Executive Officer of Urban Engineers, Inc., was selected for this honor. Ed has held this position at Urban for the past five years, after sixteen years in various technical and administrative capacities. He directs the activities of more than 350 employees who provide a broad range of engineering, design and construction management services to a long list of both private and public clients. His company is consistently ranked among the top 500 design firms and the top 100 construction management firms in the United States.

Ed has guided Urban Engineers in the completion of numerous notable projects in the Philadelphia area. Many of these are high-profile efforts and have received recognition and accolades on statewide and national levels.

Ed is a 1973 graduate of Worcester Polytechnic Institute, where he received his Bachelors degree in Civil Engineering. He obtained a Masters degree from the University of Pennsylvania in 1977. He and his family live in Berwyn.

Geotechnical Engineer of the Year

This year's recipient is **Anthony W. Eith**, a Vice President of Rust Environment and Infrastructure in Bensalem, where he manages the Solid Waste Division. Tony specializes in the design of solid waste containment facilities and methods, the control of landfill runoff and infiltration through the use of liners, and construction management and quality assurance tasks for solid waste facilities. He has managed major efforts both locally as well as in other parts of this country and the world to utilize state of the art ideas for reclamation and reuse of landfills and waste storage areas.

Tony received his Bachelors degree in Civil Engineering from the University of Louisville in 1974 and his Masters degree from Louisville one

year later. He and his family reside in Marlton, New Jersey.

Construction Engineer of the Year

Lawrence J. Bender, Jr. received these honors. Larry is the Acting Assistant Chief Engineer in the Highway Division of the Philadelphia Department of Streets. In this position, he is directly in charge of all highway construction projects administered by the Department. As Project Construction Manager, he has directed the implementation of sixty federally-funded major projects, with a total construction value of almost 140 million dollars. Among the notable projects he has directed are the currently-underway revitalization efforts on East Market Street and South Broad Street/Avenue of the Arts.

Larry is a 1968 graduate of Drexel Institute of Technology, now Drexel University, where he received his Bachelors degree in Civil Engineering. He and his family live in Roxborough.

Transportation Engineer of the Year

This year's awardee is **Robert J. Coward**, Senior Program Manager of the Rail Facilities Department of SEPTA. In this capacity, Bob directs the design and construction of major track and structure improvement projects. He has managed the replacement of various critical regional railroad bridges and the design of the restoration of the Market Street Elevated rapid transit line.

Bob received his Bachelors degree in Civil Engineering from Drexel Institute of Technology in 1970 and is currently pursuing a Masters degree at Drexel. He and his family reside in Haddonfield, New Jersey.

Educator of the Year

Dr. Richard E. Woodring, who is retiring this year after 39 years of association with Drexel University, was selected for this honor. Dick has served as a Professor in the Civil and Architectural Engineering Department at Drexel, but he has worn many hats during his tenure at the University. His other positions include Vice President for Student Life, Dean of the College of Engineering, Associate Dean, Chairman of the Civil Engineering Department, and Professor of Civil Engineering. In addition to his numerous duties at the University, Dick has played a pivotal role in the increased involvement of minority students in engineering education. In this vein, he was a co-founder of **Philadelphia Regional Introduction for Minorities to Engineering**, known better by the acronym PRIME.

Dick received his Bachelors degree in Civil Engineering from Drexel in 1954, followed by Masters and Doctorate degrees from the University of Illinois. He was recognized as the Delaware Valley Engineer of the Year in 1987. He and his wife live in Erdenheim.

Engineering Manager of the Year

John E. Durrant, this year's honoree, is the Chief of the Materials Testing Laboratory of the Philadelphia Water Department. As such, he is

responsible for the day-to-day management of testing operations and the development of laboratory programs for the City. His duties include vendor surveillance and certification, material failure analysis and various analytical services. He has been instrumental in the planning of a predictive maintenance testing program for the Department's treatment plants.

John is a 1976 graduate of Villanova University where he obtained his Bachelor degree in Civil Engineering, with a subsequent Masters degree from Villanova in 1980. He has been continually active in ASCE at both the Section and National levels. He served in various capacities in the Section, including Section President in 1984-85, and was the District 4 Director from 1989 to 1992. He and his family are residents of Chestnut Hill.

The Section greatly appreciates the fine work of the Spring Social and Awards Committees in the assembly and preparation of yet another fine event and presentation. The 1995-96 Social is tentatively scheduled for **Friday, May 10, 1996**. Watch THE NEWS for more details.

SPRING SOCIAL HIGHLIGHTS



Phila. Section, ASCE President Bill Thomsen presents "Philadelphia Civil Engineer of the Year Award" to Edward M. D'Alba, President and CEO of Urban Engineers, Inc.

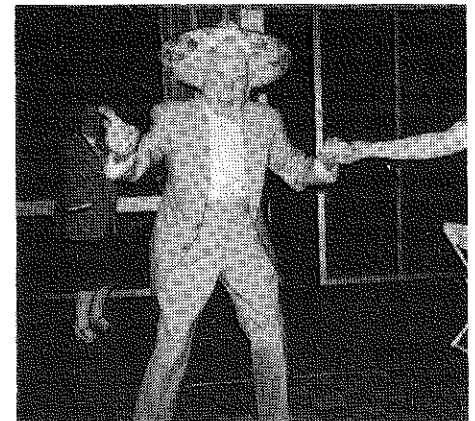

On the lighter side THE NEWS Editor Sid Robin bounces into the dance spirit of "Cinco de Mayo."

PHILADELPHIA SECTION CIVIL ENGINEERING "FOCUS"

ASCE Philadelphia Section will initiate a special "Focus" on Consulting Firms, Agencies or Manufacturers at their monthly meetings beginning in October, 1995. **Urban Engineers, Inc., City of Philadelphia Department of Streets and Tony DePaul & Son** will present the "West River Drive Improvement Project" at the October 12th, 1995 Section Meeting to start things off. This will occur through the use of Presentation Boards or Exhibit Materials focused on the capabilities of agencies and firms on the unique characteristics of projects that have been undertaken in the Philadelphia area. We look forward to these presentations as an opportunity to meet the engineers throughout our community and gain a better understanding of current and new projects or technologies. There are still three remaining openings for the November Section Meeting and one remaining opening for the March Meeting. See THE NEWS for the meeting times, locations and topics.

We will provide a limited space to those who would like to volunteer to set up a presentation which will be of interest to the Society. We will make every effort to provide as much diversity as we can. If you are interested call the **HOTLINE (215) 934-3639**.

The following are the criteria for ASCE's Civil Engineering FOCUS:

- The Company, Supplier, Manufacturer, or Agency must be actively working or supplying within the greater Philadelphia area.
- Presentations shall be limited to information describing the firm, agency, and Civil Engineering project or Civil Engineering aspect of a project. Presentations displaying new or innovative aspects of Civil Engineering are preferred.
- Agency presentations shall focus on their scope of authority, current projects or future plans.
- Manufacturer presentations shall display new and innovative product lines.
- Presentations shall be limited to information which can be visually presented on boards which are not greater than 10 ft. wide.
- Presenters shall be limited to one presentation every 2 years, unless the Board of Directors believes additional presentation offers a significant contribution to the membership.
- Presentations will be scheduled as time and space permits, generally on a first come, first serve basis. We will, however, limit the presenters to a maximum of one agency, one consultant and one manufacturer or supplier per meeting. This is intended to limit the potential for a competitive environment. Some effort will also be made to coordinate presentations with speaker topics.

**RESOLVE TO ATTEND ALL MONTHLY
SECTION MEETINGS AND FUNCTIONS...
AND INVITE YOUR CLIENTS,
ASSOCIATES AND COLLEAGUES
TO COME ALONG WITH YOU!**

April Dinner Meeting

(Continued from Page 4)

airport's operations. The new runway will double airfield capacity during periods of low visibility and decrease delays currently costing airlines about \$70 million a year.

Runway 8-26 requires the acquisition of 240 additional acres of commercial/industrial property, including the 715,000 sq. ft. Strawbridge & Clothier warehouse. In order to clear structural obstacles at the Navy Yard, the east end of the runway will be elevated about 27 feet higher than the west end. The existing rail line and roadway at the east end must be relocated and run under the runway through a tunnel.

In addition to these challenges, part of the runway will be built atop the old Enterprise Avenue Landfill (EAL), one of the first closed Superfund hazardous waste sites. Due to this location, the EPA has established a number of requirements including:

- Dewatering of the EAL site,
- Placing a cap above the landfill,
- Monitoring the surrounding groundwater,
- Designing a groundwater mitigation system, and
- Mitigating the taking of 22 acres of wetlands.

Scheduled for completion by 2001, this project will have a major economic impact by generating 2200 jobs over the next 15 years.

Audience Discussion and Q&A Period

Mary Rose ended her dynamic and informative presentation by responding to a series of questions from the enthusiastic audience. She also took time to thank the engineering community in the Delaware Valley for their contribution to the airport's revitalization. President Thomsen then graciously complimented Mary Rose on her willingness to participate in our program and helping to make this meeting an outstanding success. He presented her the Phila. Section's Certificate of Appreciation for her outstanding talk.

PHILADELPHIA FUTURE CITY COMPETITION

Join the Engineering Team of the Future

The Delaware Valley Engineers' Week Council is sponsoring the "Future City Competition for the Philadelphia Region in 1996." This program will involve students from up to fifty middle schools in the Delaware Valley, who will design the City of the Future, first on the computer program Simon City, and then with a model of their design.

In order to develop the program, it will be necessary for volunteer engineers to work with the students and mentor them in the design process. Philadelphia Section, ASCE members are invited to mentor teams of seventh and eighth grade students engineering cities of the future in this Fourth Annual National Engineers' Week Future City Competition. You will help your team's school win prizes and maybe even a trip to Washington, DC during Engineers' Week 1996, February 18-24. You and your employer will be recognized for your commitment to improving math and science education.

The Local National Engineers' Week Future City Competition began in September, 1995 and runs through January, 1996. Volunteer registrations are now being accepted. If you are interested, please contact **John E. Kampmeyer, P.E., Maida Engineering, Inc., 710 East Third Street, Essington, PA 19029; phone: (610) 521-5850, Fax (610) 521-5893**. Mr. Kampmeyer is the Technical Resource Coordinator for ASCE.

The cooperation of Phila. Section, ASCE would be greatly appreciated in order to make this new and exciting program a success in the Philadelphia area.

ATLSS SEMINAR SERIES

*Lehigh University
Center for Advanced Technology
for Large Structural Systems (ATLSS)
announces its Seminar Series for Fall, 1995*

October 11, 1995 (Wednesday)

Place: Sinclair Laboratory Auditorium, Lehigh's Main Campus
Dr. Avanti Shroff, Principal, Iffland Kavanagh Waterbury, New York, NY
"Bridge Inspection, Maintenance Planning, and Information Systems"

November 17, 1995 (Friday)

Place: Imbt Laboratories Auditorium, Mountaintop Campus
Dr. Stuart Chen, Associate Professor, State University of New York (SUNY) at Buffalo
"Condition Monitoring of Instrumented Structures; Use of Neural Networks"

Seminars are open to the public.

Time: 3:10 PM

Refreshments served at 2:45 pm

For additional inquiries: **Dr. John E. Bower, (610) 758-3524, Fax (610) 758-5553**.

ADVERTISE IN THE NEWS...

...and help support the activities of your Section. Your business card could be here! For a low, one-time charge, you could be among the select advertisers who appear on these pages for an entire Section season (September through May/June).

If you are interested, please contact Bob Wright at (215) 686-5538 or send your inquiry to our post office box (Attention: Advertisements) for more information.

Hurry! Act Now! Good spots are still available!

THE NEWS also provides one-issue or multi-issue classified advertisements for reasonable rates.

Help support THE NEWS — the voice of your Section.

1996 YOUNGER MEMBER GROUP AWARD

The purpose of the award is to promote excellence among the Younger Member Groups of the American Society of Civil Engineers. Younger Member Groups are defined as Associate Member Forums (AMF), Younger Member Forums (YMF), Younger Member Committees (YMC), etc. which operate at the Section and Branch level. It does not include Younger Member Councils. The award was officially instituted by action of the Society on July 9, 1985.

The award is known as the Younger Member Group Award. It is made annually to the most outstanding Younger Member Group of the American Society of Civil Engineers. Certificates of Commendation may also be awarded.

The Committee on Younger Members (CYM) shall recommend the winner of the award and those Groups receiving Certificates of Commendation.

The award shall consist of a framed certificate to be presented to the Younger Member Group at an Annual Convention meeting of the Society.

Up to two awards will be made each year. One Younger Member Group in each size category is eligible to receive the award. Size categories consist of large Sections and Branches (Section membership greater than 1,000 and Branch membership greater than 250; and small Sections and Branches with Section membership of 1,000 or less and Branch membership of 250 or less).

RULES

- The evaluation process involves scoring of nomination documents submitted by Younger Member Groups. The nomination documents should list professional, technical, social and special activities sponsored by the Younger Member Group for the preceding calendar year.
- Younger Member Groups may submit written nomination forms which are available from ASCE at the address below.
- Previous award recipients are eligible to reapply.
- By February 1, 1996, seven copies of the nomination should be submitted through the Section or Branch Secretary to: ASCE Awards Department, 1015 15th St. NW, Suite 600, Washington, DC 20005.

YMF NEWS

(Continued from page 3)

versity/Shriner's Hospital Project.

Wendy Oliver, of Woodward-Clyde Consultants, Plymouth Meeting, won the Daniel W. Mead paper competition for Zone I last year. (See separate article on the Mead Paper Competition elsewhere in this issue of THE NEWS.)

YMF members interested in entering the Mead Competition should contact Allen Cadden, President of YMF, at Schnabel Engineering Assoc., 882 Matlack St., Suite 206, West Chester, PA 19382, Phone (610) 696-6066.

1996 DANIEL W. MEAD CONTEST FOR YOUNGER MEMBERS

The Daniel W. Mead Prize for Younger Members was established in 1939 to honor the memory and accomplishments of the 67th President of the American Society of Civil Engineers. The talents of many of the leaders of the profession were first recognized in previous contests for this significant professional honor. The current contest provides another opportunity for alert young civil engineers to further their professional development and gain national attention.

Papers must be written on:

- "Does ASCE Have a Responsibility to Mandate Continuing Education in Order To:**
- A. Maintain ASCE Membership?**
 - B. Maintain Professional Licensure?"**

RULES

- Authors must be Associate Members, Members or Affiliates of the Society 32 years of age or less on February 1, 1996.
- Only one person can write each paper.
- Each Section or Branch can submit only one paper.
- Paper must contain no more than 2,000 words.
- One winner may be selected from each of the four Zones and International membership of the Society.
- The national winner, selected from the Zonal winners, will receive a wall plaque and a certificate.
- The national winner may be invited to present his/her paper at the ASCE National Convention, Washington, DC, in November, 1996.
- The paper by the national winner will be submitted for publication in **Civil Engineering**.

By February 1, 1996, seven copies of each paper must be submitted through the Section or Branch Secretary to: ASCE Awards Department, 1015 15th St. NW, Suite 600, Washington, DC 20005.

Philadelphia Section Younger Members are urged to get to work on the Mead Competition. We are proud of our past winners and want to continue to be in the forefront.

PLEASE PAY YOUR SECTION DUES!!!

The Philadelphia Section, ASCE Board of Directors respectfully urges all Section members to bring their dues up to date. If your 1995-1996 dues (\$18.00) is in arrears, please remit your check immediately. Also, send in your check (\$18.00) for 1995-1996 dues when you receive the bill from National ASCE headquarters. Thus you will be assured of Active Membership and will enjoy all the services and functions of the Philadelphia Section, including the monthly newsletter, THE NEWS.

Members not receiving THE NEWS are deprived of all the technical and social activities announcements; reviews of previous Section meetings featuring addresses by distinguished speak-

FAX BACK SERVICE

National ASCE is pleased to announce that gone are the days of waiting for ASCE-related information to arrive in the mail. Now there's **Faxback**, which will transmit that information to you more quickly and easily than ever before. **Faxback** currently contains information about ASCE membership, publications, conferences, membership benefit highlights, technical activities information, mailing labels/lists procedures and order forms, just to name a few. Of course, Field Services features such items as requisition forms for ordering member supplies, binders, portfolios, past president pins, past chair pins and customized certificates. You can get a quick response from **Faxback**, 24 hours a day, seven days a week.

Here's how it works: Just dial 212-705-8800 from your own telephone and follow instructions for acquiring the information you need. That material will be faxed back to you within minutes.

Members are urged to take advantage of **Faxback**, which is free of charge. A catalog list of topics can be faxed by choosing option 2 from the voice menu, or you can use the quick pick (option 3) to obtain a voice listing of available information.

Applicad Training Center, Inc.

Application Software Training

Site Design Basics (Site Works)
 Cogo Layout Basics (CogoWorks)
 Road Design Basics (InXpress)
 Civil Design Basics (InRoads)

MicroStation Training

MicroStation 2D - Level 1
 MicroStation 2D - Level 2
 MicroStation 3D

New Courses to Be Added in 1996 !!!

GEOPAK Road
 MicroStation For Managers
 InRoads / InXpress For Managers

□ 35 min. from DC & 20 min. from Baltimore
 □ INTERGRAPH Training Partner

Call for Training Schedule -



Applicad Training Center, Inc.
 14504 Greenview Drive, Suite 506
 Laurel, MD 20708
 Tel (301) 725-3922
 1(800) 859-9910
 Fax (301) 725-3926

ers; updating of National and Local official reports; Members in the News, and the numerous miscellaneous subjects covered in the monthly issues.

So—if you are in arrears, please do yourself and your Section a service, by mailing your check including the Philadelphia Section dues of \$18 per year, with the dues bill(s) which you have received from National Headquarters in New York. Only thus will you enjoy all the benefits that accrue with receipt of the monthly issues of the Philadelphia Section newsletter, THE NEWS.

Mail your checks, payable to Philadelphia Section, ASCE, P.O. Box 58186, Philadelphia, PA 19102-8186.

JOIN THE SECTION'S TECHNICAL GROUPS

Architectural Engineering

Thomas Babacz, Chairman
STV Group
11 Robinson St.
Pottstown, PA 19464
(610) 326-4600

Liaison

Darin L. Gatti
Phila. Dept. of Streets
MSB, 8th Floor
Philadelphia, PA 19103
(215) 686-5541

Younger Member Forum

Allen W. Cadden, President
Schnabel Engineering Assoc.
882 S. Matlack St.
West Chester, PA 19382
(610) 696-6066

Construction

Brian Stover, Chairman
Urban Engineers, Inc.
530 Walnut St., 16th Fl.
Philadelphia, PA 19106
(215) 923-5077

Structural

Richard Roberts, Chairman
Pennoni Associates, Inc.
1600 Callowhill St.
Phila., PA 19130
(215) 561-0460

Transportation

Gregory Yates, Chairman
Urban Engineers, Inc.
530 Walnut St., 16th Fl.
Philadelphia, PA 19106
(215) 983-5077

Engineering Management

Dennis MacBride, Chairman
SEPTA - Eng'g & Construction
1234 Market St.
Phila., PA 19107
(215) 580-7084

Geotechnical

Dr. Joseph P. Martin, Chairman
Drexel University
Civil Engineering Dept.
32nd & Chestnut Sts.
Philadelphia, PA 19104
(215) 895-2363

Timothy M. Loumakis, Associate Chairman

CH2M Hill
1700 Market St., Suite 1600
Phila., PA 19103
(215) 563-4220

Water Resources & Environmental Engineering

Raymond A. Lees, Chairman
Groundwater Technology, Inc.
223 Wilmington-West Chester Pike
Chadds Ford, PA 19317
(610) 558-1730

IMPORTANT! 1995-1996 MEETING NOTICES

MARK YOUR CALENDAR for the dates of the Philadelphia Section, ASCE monthly meetings and social functions, as follows: (Check each upcoming edition of THE NEWS for additional details, possible date and topic changes.) THIS IS A TENTATIVE LIST.

ALL DINNER MEETINGS (Except as noted)

Cocktails - 5:30 p.m. Dinner - 6:30 p.m. Meeting - 7:30 p.m.

STUDENTS: All dinner and/or luncheon charges one-half price. If you prefer, you are welcome to attend all meetings after dinner or luncheon, at no charge.

Thursday, October 12, 1995 - Dinner Meeting. Joint Meeting with PSPE. Williamson's City Line. "Port Development" sponsored by the Engineering Management Group. Villanova University Night

Thursday, November 9, 1995 - Dinner Meeting. Joint Meeting with APWA. Williamson's City Line. "City-Wide Geographic Information System" (sponsor to be determined.) Swarthmore College Night.

Thursday, December 14, 1995 - Tour of Spectrum II. Sponsored by the Construction Group.

Thursday, January 17, 1996 - Dinner Meeting. Joint Meeting with ASCE/Reading Branch. King of Prussia Holiday Inn. "New PennDOT Secretary" sponsored by ASHE & Transportation Group.

Thursday, February 13, 1996 - Dinner Meeting. Joint Meeting with ASCE/South Jersey Branch, NJ Section. Harbor League Club. "Walt Whitman Bridge Rehabilitation Project" sponsored by the Structural Group. Temple University Night.

March 1996 - Geotechnical Seminar. Drexel University. Date to be determined.

Thursday, March 14, 1996 - Dinner Meeting. Williamson's City Line. Joint Meeting with Society of American Military Engineers (S.A.M.E.) "PHL Airport Runway Project" sponsored by the Water and Environment Group. Widener University Night.

Thursday, April 11, 1996 - Dinner Meeting. Joint Meeting with SAME. Harbor League Club. Topic to be determined.

Friday, May 10, 1996 - Annual Spring Dinner Dance, Sugarloaf Conference Center

Friday, May ?, 1996 - Golf Outing. Location and date to be determined.



TEMPLE UNIVERSITY
A Commonwealth University
College of Engineering

Dr. Frederick C. Schmitt, P.E.
Civil Engineering Department

12th & Norris Streets
Philadelphia, PA 19122
(215) 204-7724 Fax: (215) 204-6936

The Hochberg Services Group, Inc.
Value Engineering Services

Morris M. Hochberg, P.E.
Certified Value Specialist
VE Team Leader

8625 Charter Club Circle, Suite 505
Fort Myers, Florida 33919

813/481-2249



**Pennoni
Associates Inc.**
Consulting Engineers

"Providing
Engineering
Services
Since 1966"

1600 Callowhill St.
Philadelphia, PA
215-561-0460



Craig R. Calabria, P.E.

GeoSystems Consultants
Engineering, Earth Sciences and
Geotechnical Laboratory Testing

575B Virginia Drive
Fort Washington, PA 19034

Telephone: 215-654-9600
Fax: 215-643-9440